

## Overview of Testing Results for Lead in Drinking Water and Corrective Actions for Naval Air Station (NAS) Oceana School-Aged Child/Youth Center Building 526

The Navy is committed to maintaining safe drinking water on its installations. City of Virginia Beach water supplied to the Navy's water distribution system is regularly tested in compliance with the Safe Drinking Water Act. Exposure to lead is one particular concern because it is a toxic metal that has a range of adverse health effects, including slowed physical and mental development and poor classroom performance in young children. Lead in drinking water may come from the existing plumbing inside buildings, including fittings, solder, water coolers, or water faucets.

The safety and wellness of youth at installation care facilities is one of the top priorities. To reduce children's potential exposure to lead, Navy policy requires that we test the lead content of drinking water in priority areas such as youth centers, child development homes, and child development centers every five years.

In September 2024, Navy environmental personnel conducted lead testing for drinking water at School-Age Child/Youth Center Building 526 in accordance with Navy and United States Environmental Protection Agency (EPA) guidelines. Water samples were sent to James R. Reed & Associates, a state-certified laboratory, for analysis.

At Building 526, water from outlets used for drinking, cooking, and washing was tested. Out of 33 samples, all drinking water tested less than the 10 parts per billion (ppb) screening level for lead, which is a level designated by the EPA to guide whether additional action is necessary.

A summary of all test results is included for your information in the following enclosures:

- **Enclosure 1:** Summary of results
  - **Table 1 Summary of Results** summarizes the data by category of use. The table provides a description of each sampling location using four columns; *Category*, *Outlet No.*, *Sample Identification*, and *Outlet Description*. The *Category* column contains information about whether the outlet is used for drinking water (water fountain), cooking (food preparation), or washing (primarily handwashing). The *Outlet No.* is the inventory number for the outlets at the facility. The *Sample Identification* column is the unique identification used to label each sample bottle. The *Outlet Description* column contains additional information to describe the outlet sampled under each category. The next set of columns in **Table 1** provides *Initial Sampling Results*. EPA sampling protocol requires water to not be used from 8 to 18 hours prior to first draw sampling, to the extent practicable. Therefore, the *Initial Sampling Results* were from first draw samples collected in the early morning.
  - **Table 2 Summary of Statistics** summarizes all data collected at the building during this event.
- **Enclosure 2:** Floor plan of NAS Oceana School-Age Child/Youth Center Building 526 and a summary of the outlets tested.

Enclosure 1  
Priority Areas Lead Testing and Corrective Actions  
NAS Oceana, SAC/Youth Center, Building 526

Table 1. Summary of Results

SAMPLING LOCATION DESCRIPTION				INITIAL SAMPLING RESULTS			RE-SAMPLING RESULTS			CORRECTIVE ACTIONS	POST REMEDIATION SAMPLING RESULTS			
CATEGORY Water Intended For:	SAMPLE IDENTIFICATION	OUTLET NO.	Outlet Description	Recommended Level = 10 parts per billion (ppb)			Water Fountain 15 min. Follow up Flush Sample - Collected day before First Draw Sampling (ppb)	First Draw (ppb)	Follow up Flush - Collected 30 seconds after First Draw Sampling (ppb)		Description	Recommended Level = 10 ppb		
				First Draw (ppb)	Retest required?	Date Fixture Secured				First Draw (ppb)		Follow up Flush - Collected 30 seconds after First Draw Sampling (ppb)	First Draw (ppb)	Follow up Flush - Collected 30 seconds after First Draw Sampling (ppb)
SAMPLING DATE RESULTS DATE				9/20/2024										
				9/30/2024										
DRINKING	OC-526-LOUNGE-WFCOMB-FD	4	Break Room 110 water fountain outlet from combination sink	non-detect	No	N/A	N/A	N/A	N/A	N/A	N/A	N/A	N/A	
DRINKING	OC-526-HALL-WFBA-FD	6	Hallway water fountain (bubbler)	non-detect	No	N/A	N/A	N/A	N/A	N/A	N/A	N/A	N/A	
DRINKING	OC-526-HALL-WFBB-FD	7	Hallway water fountain (bubbler)	non-detect	No	N/A	N/A	N/A	N/A	N/A	N/A	N/A	N/A	
DRINKING	OC-526-HALL-WFBC-FD	11	Hallway water fountain (bubbler)	non-detect	No	N/A	N/A	N/A	N/A	N/A	N/A	N/A	N/A	
DRINKING	OC-526-HALL-WFBD-FD	12	Hallway water fountain (bubbler)	non-detect	No	N/A	N/A	N/A	N/A	N/A	N/A	N/A	N/A	
DRINKING	OC-526-RM126-WFCOMB-FD	17	Game Room 126 water fountain from combination sink	non-detect	No	N/A	N/A	N/A	N/A	N/A	N/A	N/A	N/A	
DRINKING	OC-526-RM125-WFCOMB-FD	19	Skills Shop 125 water fountain from combination sink	non-detect	No	N/A	N/A	N/A	N/A	N/A	N/A	N/A	N/A	
DRINKING	OC-526-RM124-WFCOMB-FD	21	Performing Arts Room 124 water fountain from combination sink	non-detect	No	N/A	N/A	N/A	N/A	N/A	N/A	N/A	N/A	
DRINKING	OC-526-RM123-WFCOMB-FD	24	Art Room 123 water fountain from combination sink	non-detect	No	N/A	N/A	N/A	N/A	N/A	N/A	N/A	N/A	
DRINKING	OC-526-RM122-WFCOMB-FD	26	STEM Room 122 water fountain from combination sink	non-detect	No	N/A	N/A	N/A	N/A	N/A	N/A	N/A	N/A	
DRINKING	OC-526-RM121-WFCOMB-FD	28	Preschool 2 Room 121 water fountain from combination sink	non-detect	No	N/A	N/A	N/A	N/A	N/A	N/A	N/A	N/A	
DRINKING	OC-526-RM120-WFCOMB-FD	30	Preschool 1 Room 120 water fountain from combination sink	non-detect	No	N/A	N/A	N/A	N/A	N/A	N/A	N/A	N/A	
DRINKING	OC-526-OUT-WFBA-FD	35	Water fountain (bubbler) on southeast side of Building 526	non-detect	No	N/A	N/A	N/A	N/A	N/A	N/A	N/A	N/A	
DRINKING	OC-526-OUT-WFBB-FD	36	Water fountain (bubbler) on southeast side of Building 526	non-detect	No	N/A	N/A	N/A	N/A	N/A	N/A	N/A	N/A	
COOKING	OC-526-RM116-KA-FD	32	Kitchen 116 kitchen sink A used for dishwashing and food preparation	non-detect	No	N/A	N/A	N/A	N/A	N/A	N/A	N/A	N/A	
COOKING	OC-526-RM116-KB-FD	33	Kitchen 116 kitchen sink B used for dishwashing and food preparation	non-detect	No	N/A	N/A	N/A	N/A	N/A	N/A	N/A	N/A	
WASHING	OC-526-BATH1-HHW-FD	2	Bathroom 1 high hand washing faucet with motion sensor	non-detect	No	N/A	N/A	N/A	N/A	N/A	N/A	N/A	N/A	
WASHING	OC-526-LOUNGE-HWCOMB-FD	3	Break Room 110 high hand washing faucet from combination sink	non-detect	No	N/A	N/A	N/A	N/A	N/A	N/A	N/A	N/A	
WASHING	OC-526-BATH2-HHW-FD	5	Bathroom 2 high hand washing faucet with motion sensor	non-detect	No	N/A	N/A	N/A	N/A	N/A	N/A	N/A	N/A	
WASHING	OC-526-BATHB-HHWA-FD	8	Boys' Bathroom high hand washing faucet with motion sensor	non-detect	No	N/A	N/A	N/A	N/A	N/A	N/A	N/A	N/A	
WASHING	OC-526-BATHB-HHWB-FD	9	Boys' Bathroom high hand washing faucet with motion sensor	non-detect	No	N/A	N/A	N/A	N/A	N/A	N/A	N/A	N/A	
WASHING	OC-526-BATHB-HHWC-FD	10	Boys' Bathroom high hand washing faucet with motion sensor	non-detect	No	N/A	N/A	N/A	N/A	N/A	N/A	N/A	N/A	
WASHING	OC-526-BATHG-HHWA-FD	13	Girls' Bathroom high hand washing faucet with motion sensor	non-detect	No	N/A	N/A	N/A	N/A	N/A	N/A	N/A	N/A	
WASHING	OC-526-BATHG-HHWB-FD	14	Girls' Bathroom high hand washing faucet with motion sensor	non-detect	No	N/A	N/A	N/A	N/A	N/A	N/A	N/A	N/A	
WASHING	OC-526-BATHG-HHWC-FD	15	Girls' Bathroom high hand washing faucet with motion sensor	non-detect	No	N/A	N/A	N/A	N/A	N/A	N/A	N/A	N/A	
WASHING	OC-526-RM126-HWCOMB-FD	16	Game Room 126 high hand washing faucet from combination sink	non-detect	No	N/A	N/A	N/A	N/A	N/A	N/A	N/A	N/A	
WASHING	OC-526-RM125-HWCOMB-FD	18	Skills Shop 125 high hand washing faucet from combination sink	non-detect	No	N/A	N/A	N/A	N/A	N/A	N/A	N/A	N/A	
WASHING	OC-526-RM124-HWCOMB-FD	20	Performing Arts Room 124 high hand washing faucet from combination sink	non-detect	No	N/A	N/A	N/A	N/A	N/A	N/A	N/A	N/A	
WASHING	OC-526-RM123-HWCOMB-FD	23	Art Room 123 high hand washing faucet from combination sink	non-detect	No	N/A	N/A	N/A	N/A	N/A	N/A	N/A	N/A	
WASHING	OC-526-RM122-HWCOMB-FD	25	STEM Room 122 high hand washing faucet from combination sink	non-detect	No	N/A	N/A	N/A	N/A	N/A	N/A	N/A	N/A	
WASHING	OC-526-RM121-HWCOMB-FD	27	Preschool 2 Room 121 high hand washing faucet from combination sink	non-detect	No	N/A	N/A	N/A	N/A	N/A	N/A	N/A	N/A	
WASHING	OC-526-RM120-HWCOMB-FD	29	Preschool 1 Room 120 high hand washing faucet from combination sink	non-detect	No	N/A	N/A	N/A	N/A	N/A	N/A	N/A	N/A	
WASHING	OC-526-RM116-HHW-FD	31	Kitchen 116 high hand washing faucet with motion sensor	non-detect	No	N/A	N/A	N/A	N/A	N/A	N/A	N/A	N/A	

Enclosure 1  
Priority Areas Lead Testing and Corrective Actions  
NAS Oceana, SAC/Youth Center, Building 526

Table 2. Summary Statistics

CATEGORY	INITIAL SAMPLING RESULTS	RE-SAMPLING RESULTS			POST REMEDIATION RESULTS
	Recommended Level = 10 parts per billion (ppb)				
	First Draw	Water Fountain Follow up Flush Sample - Collected day before First Draw Sampling	First Draw	Follow up Flush - Collected 30 seconds after First Draw Sampling	First Draw
Total Drinking	14	0	0	0	0
Total Drinking > 10 ppb	0	0	0	0	0
Total Cooking	2	0	0	0	0
Total Cooking > 10 ppb	0	0	0	0	0
Total Washing	17	0	0	0	0
Total Washing > 10 ppb	0	0	0	0	0
Total Samples	33	0	0	0	0
Total Samples > 10 ppb	0	0	0	0	0

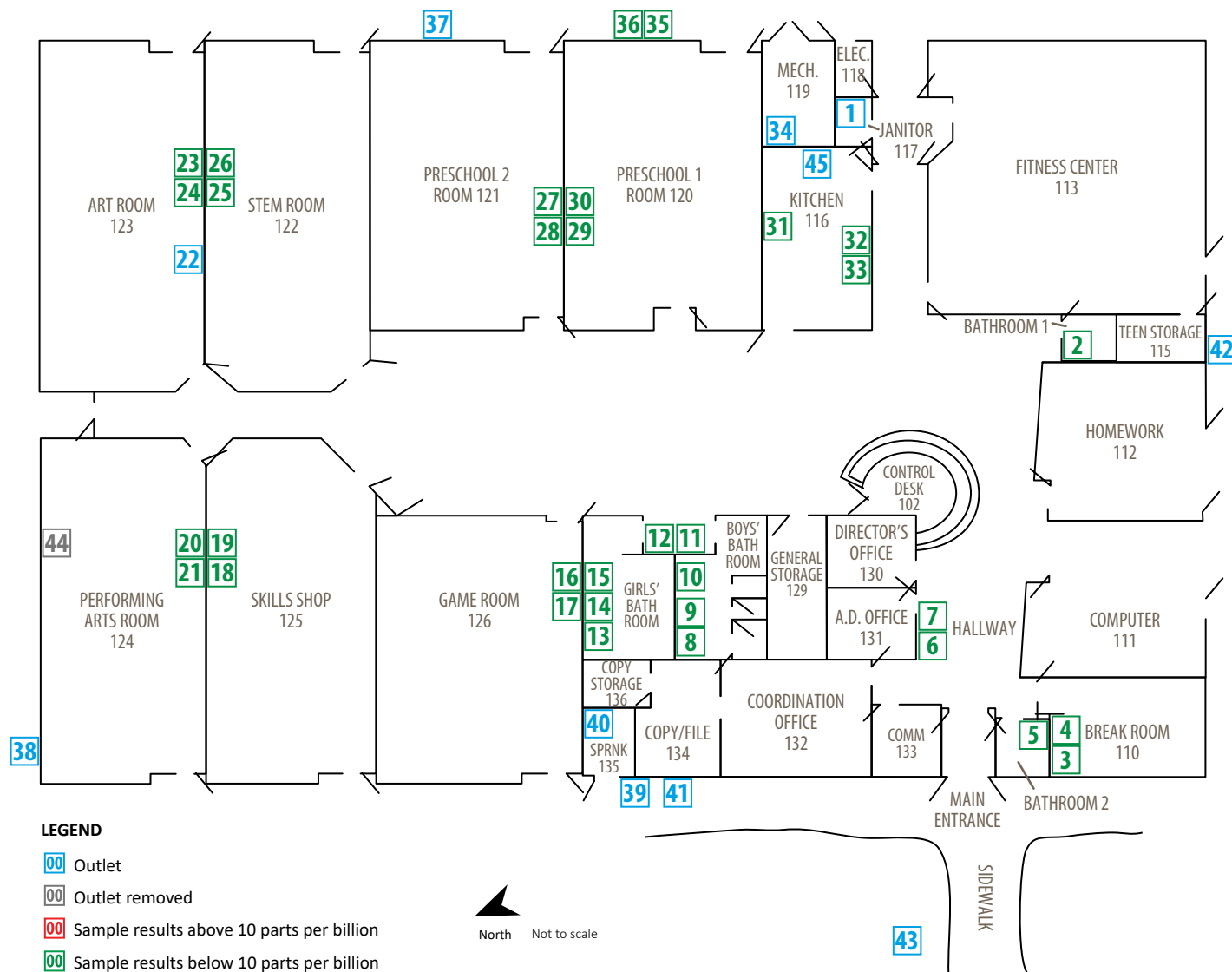

Outlet No.	Type of Fixture	Location Description	Exceeded?
1	Utility sink	Janitor Closet 117	Not sampled – not used for drinking
2	High hand washing faucet with motion sensor	Bathroom 1	No
3	High hand washing faucet from combination sink	Break Room 110	No
4	Water fountain from combination sink	Break Room 110	No
5	High hand washing faucet with motion sensor	Bathroom 2	No
6	Water fountain (bubbler)	Hallway	No
7	Water fountain (bubbler)	Hallway	No
8	High hand washing faucet with motion sensor	Boys' Bathroom	No
9	High hand washing faucet with motion sensor	Boys' Bathroom	No
10	High hand washing faucet with motion sensor	Boys' Bathroom	No
11	Water fountain (bubbler)	Hallway	No
12	Water fountain (bubbler)	Hallway	No
13	High hand washing faucet with motion sensor	Girls' Bathroom	No
14	High hand washing faucet with motion sensor	Girls' Bathroom	No
15	High hand washing faucet with motion sensor	Girls' Bathroom	No
16	High hand washing faucet from combination sink	Game Room 126	No
17	Water fountain outlet from combination sink	Game Room 126	No
18	High hand washing faucet from combination sink	Skills Shop 125	No
19	Water fountain from combination sink	Skills Shop 125	No
20	High hand washing faucet from combination sink	Performing Arts Room 124	No
21	Water fountain from combination sink	Performing Arts Room 124	No
22	Utility sink	Art Room 123	Not sampled – not used for drinking
23	High hand washing faucet from combination sink	Art Room 123	No
24	Water fountain from combination sink	Art Room 123	No
25	High hand washing faucet from combination sink	STEM Room 122	No
26	Water fountain outlet from combination sink	STEM Room 122	No
27	High hand washing faucet from combination sink	Preschool 2 Room 121	No
28	Water fountain from combination sink	Preschool 2 Room 121	No
29	High hand washing faucet from combination sink	Preschool 1 Room 120	No
30	Water fountain from combination sink	Preschool 1 Room 120	No
31	High hand washing faucet with motion sensor	Kitchen 116	No
32	Kitchen sink for dishwashing and food preparation	Kitchen 116	No
33	Kitchen sink for dishwashing and food preparation	Kitchen 116	No
34	Hose bib	Mechanical Room 119	Not sampled – not used for drinking
35	Water fountain (bubbler)	Southeast side of Building 526	No
36	Water fountain (bubbler)	Southeast side of Building 526	No
37	Hose bib	Southeast side of Building 526	Not sampled – not used for drinking
38	Hose bib	Northeast side of Building 526	Not sampled – not used for drinking
39	Hose bib	Northwest side of Building 526	Not sampled – not used for drinking
40	Hose bib	Sprinkler Room 135	Not sampled – not used for drinking
41	Hose bib	Northwest side of Building 526	Not sampled – not used for drinking
42	Hose bib	Southwest side of Building 526	Not sampled – not used for drinking
43	Fire hydrant with hose connection	Northwest side of Building 526	Not sampled – not used for drinking
44	Prop sink	Performing Arts Room 124	Outlet removed
45	Ice maker	Kitchen 116	Not sampled – ice maker